

# CONCRETE FLOOR OR WALL CABLE TRAY

**F Rating 3 Hr.**

**T Rating 0, 3/4 & 2 Hr.**

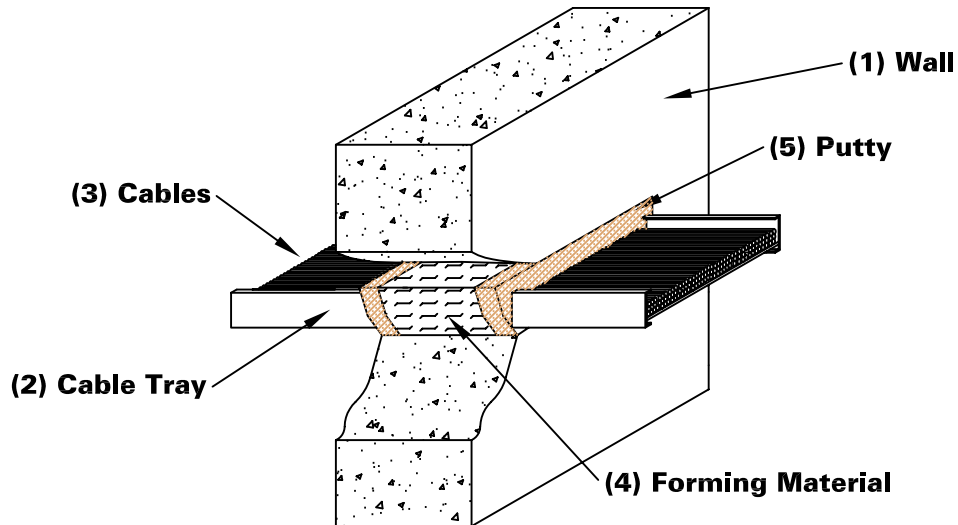

1. FLOOR or WALL ASSEMBLY - Min. 4-1/2" (114mm) lightweight or normal weight concrete floor or wall or CMU block wall. The max. size of the opening is 7" x 21" (178mm x 533mm).
2. CABLE TRAY - Max. 18" x 4" (457mm x 102mm) open ladder type, steel, cable tray. Center tray in the opening. The annular space between cable tray and edge of the opening is 1-1/2" (38mm).
3. CABLES - Max. 20-39% cable fill in any combination of:
  - (A) max. #2awg multiconductor power and control cable w/cross linked polyethylene (XLPE) insulation and polyvinyl chloride (PVC) jacket. When these cables are used exclusively, the T rating is 3/4 Hr.
  - (B) max. #12awg multiconductor control cable w/(XLPE) insulation and jacket. When these cables are used exclusively, the T rating is 2 Hr.
  - (C) max. 300 kcmil single conductor power cable w/(XLPE) insulation. When these cables are used exclusively, the T rating is 0 Hr.
4. FORMING MATERIAL - Tightly pack min. 6pcf (96 kg/cubic meter) mineral wool in and around cables for separation of cables to a 3" (76mm) depth. Recess 3/4" (19mm) from each floor or wall surface.
5. NELSON FSP PUTTY (part # AA445) - Apply FSP within the annulus on both surfaces, within and around the cables over forming material to a min. depth of 3/4" (19mm) depth, with an additional 1" (25mm) crown around the penetrating item.

Tested in accordance with:  
ASTM E-814  
ANSI/UL 1479



**System No.  
C-AJ-4001**

**Nelson Firestop**

**DWG NO. FS-0020 R2**

**Project Name:** \_\_\_\_\_  
**Address:** \_\_\_\_\_  
  
**Installer:** \_\_\_\_\_  
**Address:** \_\_\_\_\_  
  
**Signature:** \_\_\_\_\_

**DATE:** 07/14/06

**BY:** RL

**MEA # 196-84-M Vol.3**

**Nelson Firestop**  
**800 331-7325 Fax: 918 627-2941**  
**Tulsa, Ok.**