

CONCRETE FLOOR OR WALL CABLE TRAY

F Rating 2 Hr.

T Rating 0 Hr.

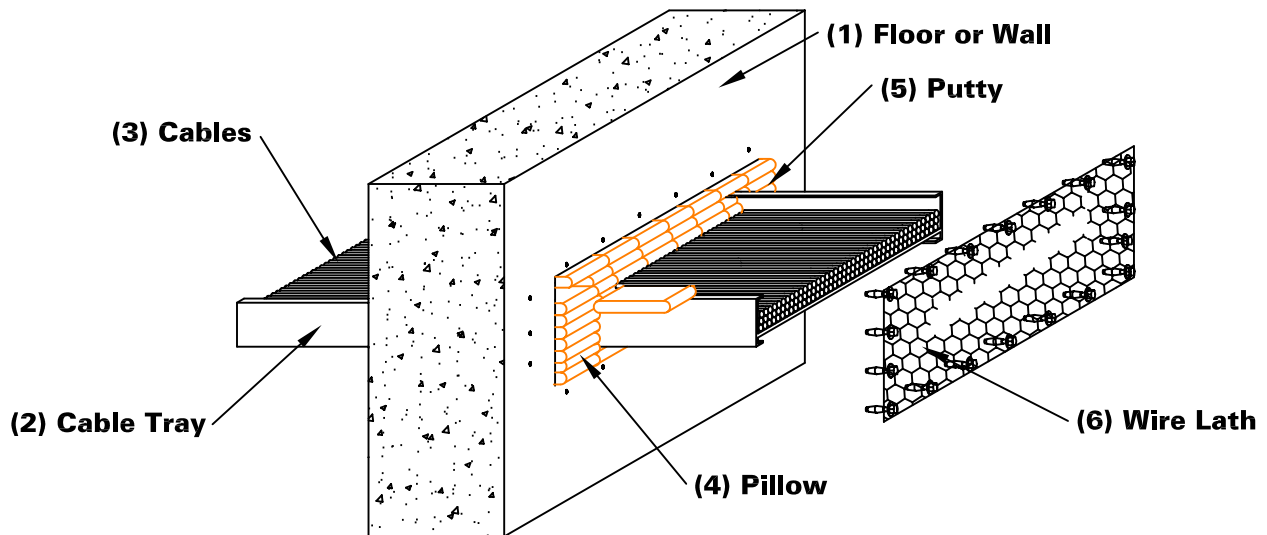

1. FLOOR or WALL - Min. 4-1/2" (114mm) concrete floor or wall or CMU block wall. The max. area is 320 sq. in. (2065 sq. cm) with max. dimension of 40" (1016mm). The annular space is 0" (point of contact) to 2" (51mm).
2. CABLE TRAY - Max. 36" x 6" (914mm x 152mm) steel, open ladder type cable tray.
3. CABLES - Max. 40% cable fill of opening in any combination of:
 - (A) max. 72 fibers 62.5/125 fiber optic cable w/polyvinyl chloride (PVC) insulation and jacket.
 - (B) max. 100pr #24 awg cable w/PVC insulation and jacket.
4. NELSON PLW PILLOW (part # AA478 or AA479) - Pillows to be installed horizontally or vertically within the opening in such a manner that the ends project a min. of 2-1/2" (64mm) beyond each surface of floor or wall. Pillows tightly packed into opening to fill the annular space between cables and periphery of opening and between cable tray and periphery of opening.
5. NELSON FSP PUTTY (part # AA445) - Where spacing does not permit installation of pillows between the cable tray and/or cables and the periphery of the opening, a min. 1-1/2" (38mm) thickness of putty applied at cable tray or cable/concrete interface on bottom surface of floor or both surfaces of wall. Putty applied to seal any voids between the cables, and the pillows and between the cable tray and the pillows on both sides of the floor or wall assembly.
6. WIRE LATH - Nominal 2" (51mm), 19awg. galv. steel wire lath, cut to fit the contour of the opening with a min. 2" (51mm) lap beyond the periphery of the opening. Wire lath secured to both surfaces of floor or wall assembly with 1/4" (6mm) diameter by 1-3/4" (44mm) long concrete anchors in conjunction with 1/4" (6mm) by 1-1/2" (38mm) diameter steel fender washers, spaced 6" OC.

Tested in accordance with:

ASTM E-814
ANSI/UL 1479



**System No.
C-AJ-4032**

Nelson Firestop

DWG NO. FS-0147 R4

DATE: 07/18/06

BY: RL

MEA # 196-84-M Vol. 3

Nelson Firestop

800 331-7325 Fax: 918 627-2941

Tulsa, Ok.

Project Name: _____
Address: _____

Installer: _____
Address: _____

Signature: _____